



CONCERTINO COLLECTION

Clarinet

INSTRUMENTS THAT OUTPERFORM

Assembly, Care & Maintenance Guide



The Name You Know

www.suzukibandinstruments.com

STOP!

Read This First Before You Assemble Your Clarinet

Did You Know This?

Your new Clarinet is manufactured by the Suzuki Corporation, the Worlds largest producer of musical instruments for education. We have been making the coolest musical instruments for your school and church for

over 50 years! And now, we've designed a Clarinet that you can learn to play quickly and easily. We know you can't wait to play in the band, marching band or orchestra and make exciting music together with all your friends. Playing a musical instrument, especially in a group, is an incredible experience. If you pay attention and study a little each day, pretty soon you will be amazed at the awesome music you will be able to perform. And your Suzuki Clarinet will perform for you too. Together, you'll both have a really great time!

This Is A Precise And Delicate Instrument . . . Be Careful With It!

The Clarinet, as with all musical instruments, is a precise, yet delicate instrument. It has hundreds of very small parts, all coming together to



create a beautiful musical instrument. You must be very careful when handling your new Clarinet, putting it together and taking it apart. We recommend that you let your music teacher show you how your new Clarinet should be assembled and dis-assembled. You'll get the hang of it very quickly. In the meantime, read through this brochure now so you can get familiar with the assembly and care of your new Clarinet. And be careful!

Wanna Get Good On Your Instrument Real Fast?

Who is your favorite band or musician? Whether you like rock, pop, country or classical, you can be sure that all the best players had one thing in common . . . a private teacher. After your music teacher has shown you the basics of how to put your instrument together and how to play a few notes, its time to get some private instruction. Your music teacher may have some recommendations or may even be the perfect private teacher you are looking for. It's a great way to get real good, real fast.

If You Have Any Problems Or Questions About Your Clarinet, Call Us Toll Free. We Can Help You.

Do Not Return Your Clarinet To The Store!

1-800-854-1594

You can also visit our web site at www.suzukibandinstruments.com

1. UNPACKING YOUR NEW CLARINET

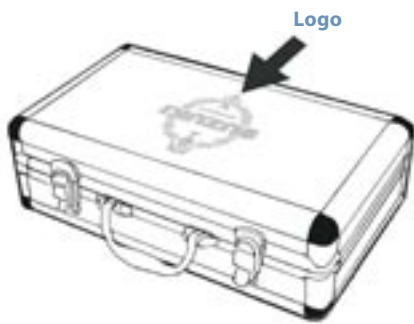

A. Position The Case

Place the aluminum "Roadie" Clarinet case in front of you as shown in this picture. You should be able to see the Suzuki logo on the case. If you do not see the logo, the case is upside down and should NOT be opened. Open the case ONLY if you can see this logo.



B. Open The Case

Unhook the 2 latches on either side of the handle and open the lid. Your new Clarinet has 5 different sections that must be CAREFULLY unwrapped. There is also a compartment with accessories.

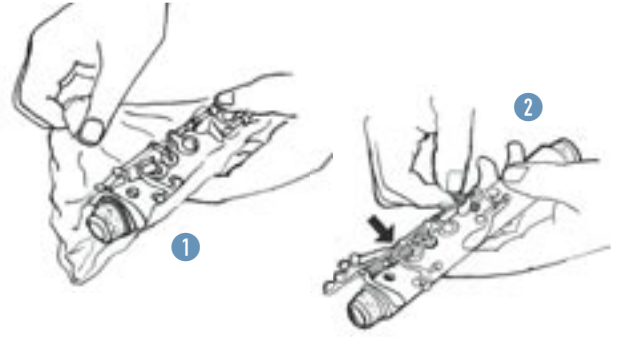

C. Unwrap Your Clarinet

- Slowly remove the plastic covering and paper wrapping on each of the 5 Clarinet sections. ①
- Small foam tabs have been inserted to protect the keys during shipping. These must now be removed and can be thrown away. ②

Carefully put the sections back in the case in their proper compartments!

2. HERE ARE THE NAMES OF YOUR CLARINET PARTS

A. Carrying Case

When you open the lid of your new Clarinet Carrying Case, you will see the 5 sections and a Storage Compartment for your accessories.

1. Mouthpiece
 - A. Cap
 - B. Mouthpiece
 - C. Ligature
2. Barrel
3. Upper Joint
4. Lower Joint
5. Bell
6. Storage Compartment

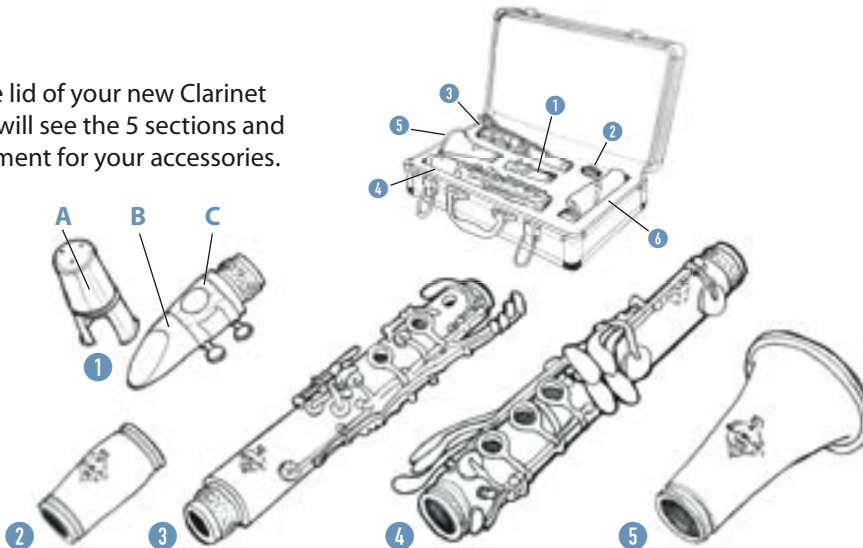

B. Accessories

Your new Clarinet includes these accessories.

1. Cork Grease
2. Reed Holder and 2 Reeds
3. Cleaning Swab
4. Polishing Cloth

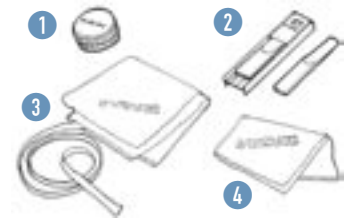

3. THIS IS WHAT YOUR CLARINET WILL LOOK LIKE WHEN ASSEMBLED

These 2 pictures show you what your Clarinet will look like when it has been completely assembled. Read the next sections to learn how to put your Clarinet together so that it looks like this when you are finished.

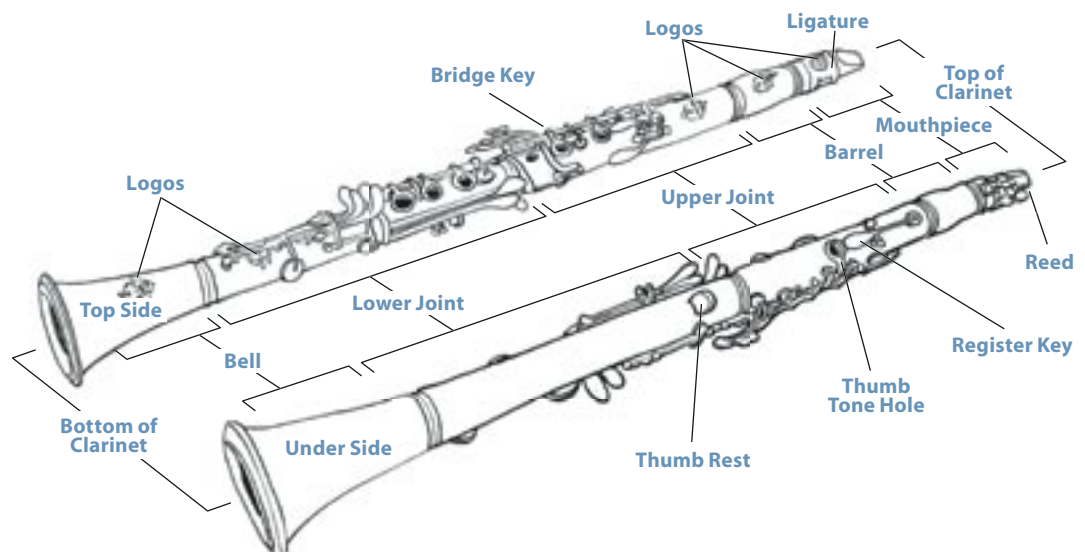

4. HOW TO PUT YOUR NEW CLARINET TOGETHER

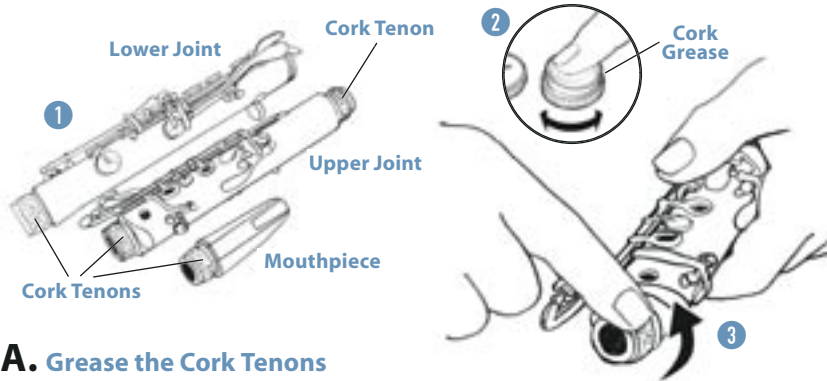

A. Grease the Cork Tenons

- Locate the Upper Joint, Lower Joint and Mouthpiece in the Case. Remove these 3 sections. These sections need a small amount of Cork Grease on each Cork Tenon. ①
- Open the Cork Grease. Put a small amount of Cork Grease on your pointer finger. ②
- Spread it all the way around the Cork. Repeat this process until all 3 sections have been greased. Then put them all back in the Case. ③
- Finally, put the top back on the Cork Grease and return the Cork Grease to the Storage Compartment.

BE CAREFUL! Hold the Clarinet sections gently! Don't squeeze the keys, they may bend!

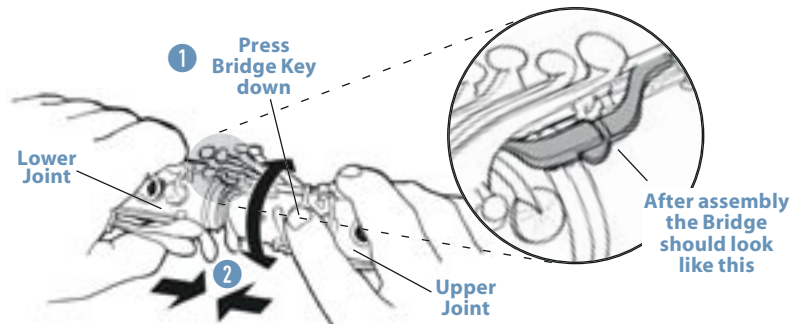

C. Now attach the Upper Joint

- Locate the Upper Joint in the Case and remove this section.
- The Upper Joint has a Bridge Key as shown. Push this Key down. This will raise the Bridge. ①
- Place the Cork end of the Lower Joint into the end of the Upper Joint and SLOWLY push them together using a back and forth motion. ②

BE CAREFUL! The bridge key must be pushed down while you are assembling these two sections or you will damage your Clarinet!

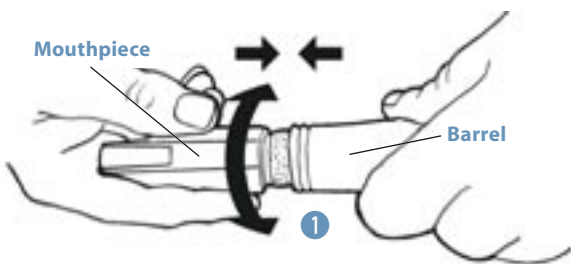

E. Finally, attach the Mouthpiece

- Locate the Mouthpiece in the case and remove this section.
- The Mouthpiece has a Cap and a Ligature on it. Remove the Cap and place it back in the case. Loosen the Ligature screws and remove it also.
- Stand the Clarinet upright and slowly push in the Mouthpiece into the Barrel as shown using a back and forth motion. ①

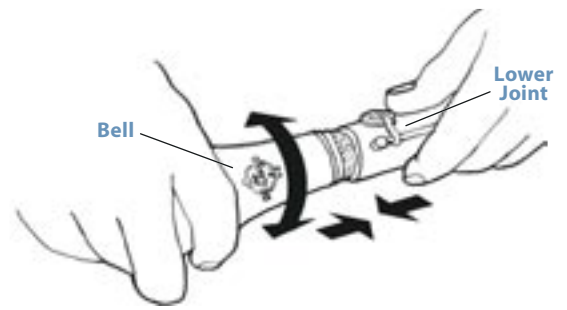

B. Attach the Bell to the Lower Joint

- Locate the Lower Joint and the Bell in the Case. Remove these 2 sections.
- Put the Cork of the Lower Section INTO the Bell.
- CAREFULLY twist the sections back and forth until the Lower Section is all the way inside the Bell. Do NOT turn the parts all the way around. Just back and forth.

BE CAREFUL! Do not force the sections together! Slowly move them back and forth. Don't squeeze the Lower Joint.

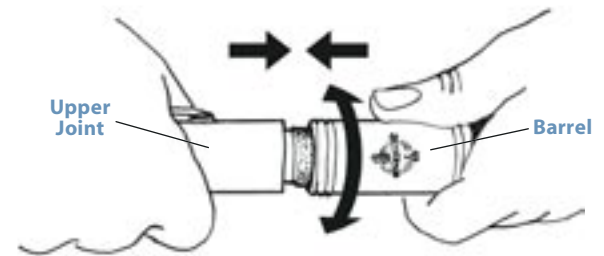

D. Now attach the Barrel

- Locate the Barrel in the Case and remove this section.
- Stand your Clarinet upright, do not lay it down.
- Push the Barrel into the Cork Tenon of the Upper Joint using the same slow back and forth motion as you did with the other sections.

BE CAREFUL! Your Clarinet is now almost assembled. It is getting longer. Be careful not to drop or hit your Clarinet on anything.

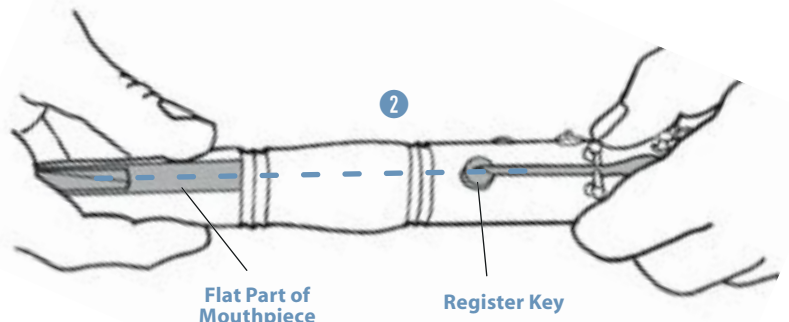

- The flat part of the Mouthpiece and the Register Key on the Upper Joint should be lined up as shown. ②

5. PREPARING YOUR MOUTHPIECE, REED AND LIGATURE

This is a very delicate stage of your Clarinet assembly so pay close attention and be careful.

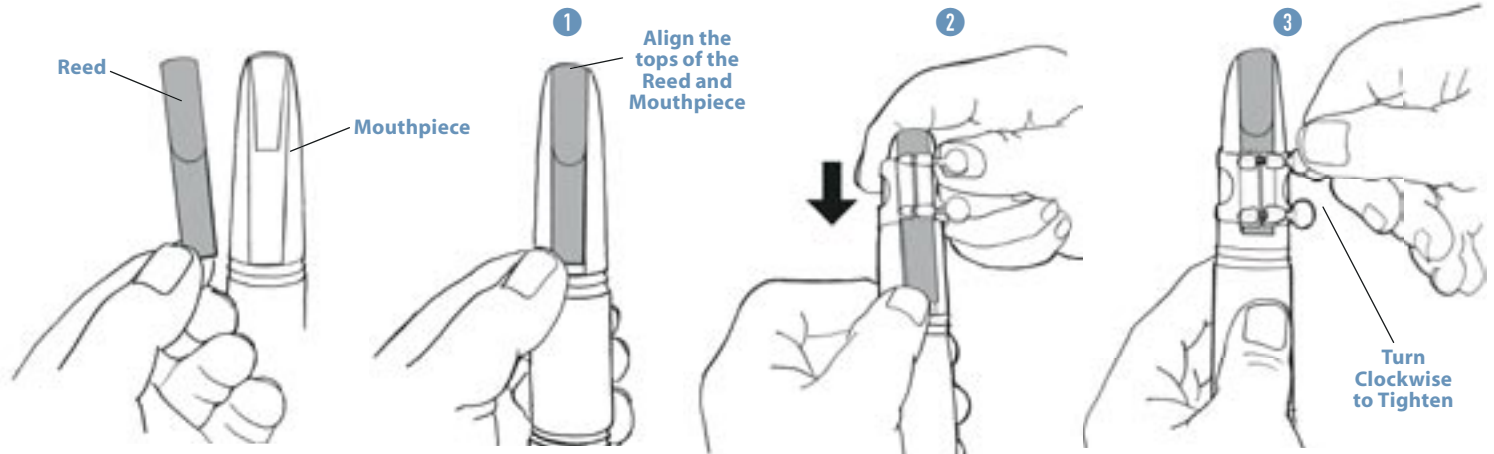

A. Installing the Reed

- Locate and remove the Reed Holder from the Storage Compartment.
- Carefully take a Reed out of the Reed Holder and place the Reed in your mouth for a minute. The Reed needs to be moistened before you can place it on the Mouthpiece.
- Now place the FLAT side of the moistened Reed on the FLAT side of the Mouthpiece. The top of the Mouthpiece and the top of the Reed should be at the same height. ①

BE CAREFUL! The top of the Reed is VERY thin and delicate. If you chip or crack it, you will have to use another Reed.

- Locate the Ligature. The screws should remain loose. While holding the Reed in position with your left thumb, CAREFULLY place the Ligature over the Mouthpiece and Reed. DO NOT TOUCH THE THIN PART OF THE REED! Push the Ligature down on the Mouthpiece so that it covers the smooth part of the Reed. ②
- Now, slowly tighten the screws on the Ligature until they are tight, but not too tight. This will hold the Reed in place while you are playing. ③
- Your Clarinet is now completely assembled and should look like the drawings in Section 3. All the logos should be lined up in exactly the same position. No single logo should be off to the left or right of the center of your Clarinet.

Your new Clarinet should now look like this. *Have fun!*



6. WHEN YOU HAVE FINISHED PLAYING YOUR CLARINET

- Loosen the Ligature. Carefully remove the Reed. Dry it with the Polishing Cloth starting at the thick end moving towards the tip. Be very careful at the tip. Return it to the Reed Holder.
- Now take off the Ligature and remove the Mouthpiece. Take the Cleaning Swab and put the weighted end into the Mouthpiece. Then, pull the Swab through the Mouthpiece.
- Next, take the Swab and put the weighted end into the Barrel of your Clarinet until it comes out the Bell. Gently pull the Swab through the Clarinet. Repeat. This will dry the inside of your Clarinet and help protect the key pads from moisture.
- Put the Ligature back on the Mouthpiece and tighten slightly. Then put the Cap over the Mouthpiece and return it to the Case.
- Remove the Barrel next. Hold the Upper Joint near the top with one hand while handling the Barrel with your other hand. Slowly twist the Barrel back and forth until it comes off. Return it to the Case.
- Now separate the Upper and Lower Joints. Press down on the Bridge Key of the Upper Joint so the bridge is raised. Slowly and carefully twist the sections back and forth until they have been separated. Do NOT turn them around and around! Return the Upper Joint to the proper Compartment in the Case.
- Hold the Bottom Joint in one hand and the Bell in the other hand. Slowly twist the Bell back and forth until it is separated from the Lower Section. Return the Lower Section and Bell to the Case.

Be careful! When removing the Reed, do not touch the tip. When separating the Upper and Lower Joints, make sure the Bridge Key is down. Do not force the parts into the Case. There is only one correct compartment for each part. Do not force the lid closed. If it does not close easily, check the placement of the parts.

Care & Maintenance

DO'S



- DO** Be careful when handling your Clarinet. It is a delicate instrument.
- DO** Swab out the Mouthpiece and Clarinet after you have finished playing.
- DO** Place each section back in the correct compartment in the Case.
- DO** Use Cork Grease on each tenon before assembling your Clarinet.
- DO** Use a gentle back and forth motion when putting together or taking apart your Clarinet sections.
- DO** Place the Cap over the Mouthpiece after you have removed the Reed.



DON'TS

- DON'T** Force the sections into the Case.
- DON'T** Close the lid if it seems difficult.
- DON'T** Eat while playing.
- DON'T** Turn the Clarinet sections around and around.
- DON'T** Press hard on the keys or rods when handling them.
- DON'T** Touch the tip of the Reed.



CONCERTINO COLLECTION
Clarinet
INSTRUMENTS THAT OUTPERFORM



The Name You Know

www.suzukibandinstruments.com